

EF TAPPING VALVE

04 Update - 05/2024

TECHNICAL DATA

Article No	001 117 2072 0211
d (mm)	200
d1 (mm)	32
le (mm)	74
h (mm)	292
h1 (mm)	183
Z (mm)	126
L (mm)	160
Weight (Kg)	2,610
Box Quantity (pcs)	5
Box Dimension (cm)	55x30x37,5

INJECTION MOULDED

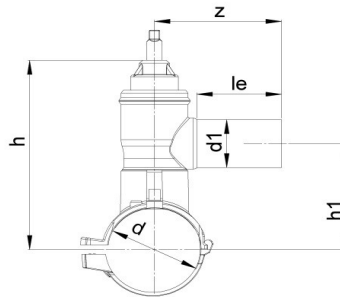

IDENTIFICATION OF PRODUCT

D(mm)	180-200x32
SDR	11
RAW MATERIAL	PE 100
PRESSURE CLASS	16 Bar Water
TRADEMARK	NTG
EXECUTION	Injection Moulded
STANDARD	EN 12201-3

EF SPECIFICATION

WELDING VOLTAGE	40 V
RESISTANCE	7.0 Ω
WELDING TIME	130 Sec.
COOLING TIME	15 Min.
WINDING TYPE	Monofilar
WELDING BARCODE	



142007322003407005130112

SPECIFICATION	<p>Suitable for SDR11....17 pipe</p> <p>4 mm pin connectors</p> <p>Long fusion outlet</p> <p>Opening on the spanner is 18 turns</p> <p>Wrench 12 mm</p> <p>The valve is closed clockwise</p>
---------------	--

Tolerance on diameters and thickness according to the standards. The other dimensions are specialized. Tolerance ± 5%. NTG PLASTIK reserves all the right to change any information without giving prior notice. The production, distribution and utilization of this document without explicit authorization is prohibited.